

SAN DIEGO COUNTY SHERIFF'S DEPARTMENT

463951
463952
PAGE 1 OF 12

TRAFFIC COLLISION REPORT

SPECIAL CONDITIONS		NO. INJURED 2	H & R PELONY <input type="checkbox"/>	CITY SANTEE	JUDICIAL DISTRICT ELCAJON			NUMBER 864288
		NO. KILLED 0	H & R MISD. <input type="checkbox"/>	COUNTY SAN DIEGO	REPORTING DISTRICT 14	BEAT 15		
LOCATION	COLLISION OCCURRED ON HAST BLVD (CS)				MO. DAY YR. 10 16 84	TIME (2400) 1500	NCIC NUMBER CA0370003	OFFICER I.D. 0855
	MILEPOST INFORMATION				INJURY FATAL OR TOW AWAY <input checked="" type="checkbox"/> YES <input type="checkbox"/> NO		STATE HIGHWAY RELATED <input type="checkbox"/> YES <input checked="" type="checkbox"/> NO	
	FEET OF MILEPOST						PHOTOGRAPHS <input type="checkbox"/> YES <input checked="" type="checkbox"/> NO	
	<input checked="" type="checkbox"/> AT INTERSECTION WITH OR: FEET/MILES OF DOLLER RD (CS)							
PARTY 1	NAME (FIRST, MIDDLE, LAST) JEANNETTE LYNN DENMAN				OWNER'S NAME <input checked="" type="checkbox"/> SAME AS DRIVER			
DRIVER	STREET ADDRESS 9455 PEARLWOOD		HOME PHONE 448 7638		OWNER'S ADDRESS <input checked="" type="checkbox"/> SAME AS DRIVER			
PEDESTRIAN	CITY/STATE/ZIP SANTEE, CAL 92071		BUSINESS PHONE -		DISPOSITION OF VEH. TAKEN		ON ORDERS OF <input type="checkbox"/> OFFICER <input checked="" type="checkbox"/> DRIVER <input type="checkbox"/> OTHER	
PARKED VEH.	DRIVER'S LICENSE NUMBER -	STATE -	BIRTHDATE MO. DAY YR. 10 22 72	SEX F	RACE W	DIRECTION OF TRAVEL N	ON/ACROSS (STREET OR HIGHWAY) HAST BLVD	SPEED LIMIT 35
BICYCLIST	VEH. YR(S) -	MAKE(S)/MODEL(S)/COLOR(S) HUFFY 10SPD	LICENSE NO.(S) NONE		CHP USE ONLY		VEHICLE DAMAGE-EXTENT/LOCATION <input type="checkbox"/> MINOR <input checked="" type="checkbox"/> MODERATE <input type="checkbox"/> MAJOR <input type="checkbox"/> TOTAL	
OTHER	GIRLS-RED				VEHICLE TYPE - 5		FRONT & LT. SIDE	
PARTY 2	NAME (FIRST, MIDDLE, LAST) LARRY SCOTT AURECH				OWNER'S NAME <input checked="" type="checkbox"/> SAME AS DRIVER			
DRIVER	STREET ADDRESS 4265 AERO DR		HOME PHONE 236 7022		OWNER'S ADDRESS <input checked="" type="checkbox"/> SAME AS DRIVER			
PEDESTRIAN	CITY/STATE/ZIP SAN DIEGO, CAL 92123		BUSINESS PHONE 236-7022		DISPOSITION OF VEH. DRIVEN		ON ORDERS OF <input type="checkbox"/> OFFICER <input type="checkbox"/> DRIVER <input type="checkbox"/> OTHER	
PARKED VEH.	DRIVER'S LICENSE NUMBER N3183213	STATE CAL	BIRTHDATE MO. DAY YR. 07 10 52	SEX M	RACE W	DIRECTION OF TRAVEL W	ON/ACROSS (STREET OR HIGHWAY) HAST BLVD.	SPEED LIMIT 35
BICYCLIST	VEH. YR(S) 80	MAKE(S)/MODEL(S)/COLOR(S) FORD MUSTANG	LICENSE NO.(S) 1JUL346 CAL		CHP USE ONLY		VEHICLE DAMAGE-EXTENT/LOCATION <input type="checkbox"/> MINOR <input checked="" type="checkbox"/> MODERATE <input type="checkbox"/> MAJOR <input type="checkbox"/> TOTAL	
OTHER	WHITE				VEHICLE TYPE - 5		LT. SIDE	
PARTY 3	NAME (FIRST, MIDDLE, LAST)				OWNER'S NAME <input type="checkbox"/> SAME AS DRIVER			
DRIVER	STREET ADDRESS		HOME PHONE		OWNER'S ADDRESS <input type="checkbox"/> SAME AS DRIVER			
PEDESTRIAN	CITY/STATE/ZIP		BUSINESS PHONE		DISPOSITION OF VEH.		ON ORDERS OF <input type="checkbox"/> OFFICER <input type="checkbox"/> DRIVER <input type="checkbox"/> OTHER	
PARKED VEH.	DRIVER'S LICENSE NUMBER	STATE	BIRTHDATE MO. DAY YR.	SEX	RACE	DIRECTION OF TRAVEL	ON/ACROSS (STREET OR HIGHWAY)	SPEED LIMIT
BICYCLIST	VEH. YR(S)	MAKE(S)/MODEL(S)/COLOR(S)	LICENSE NO.(S)		CHP USE ONLY		VEHICLE DAMAGE-EXTENT/LOCATION <input type="checkbox"/> MINOR <input type="checkbox"/> MODERATE <input type="checkbox"/> MAJOR <input type="checkbox"/> TOTAL	
OTHER								
PARTY 4	NAME (FIRST, MIDDLE, LAST)				OWNER'S NAME <input type="checkbox"/> SAME AS DRIVER			
DRIVER	STREET ADDRESS		HOME PHONE		OWNER'S ADDRESS <input type="checkbox"/> SAME AS DRIVER			
PEDESTRIAN	CITY/STATE/ZIP		BUSINESS PHONE		DISPOSITION OF VEH.		ON ORDERS OF <input type="checkbox"/> OFFICER <input type="checkbox"/> DRIVER <input type="checkbox"/> OTHER	
PARKED VEH.	DRIVER'S LICENSE NUMBER	STATE	BIRTHDATE MO. DAY YR.	SEX	RACE	DIRECTION OF TRAVEL	ON/ACROSS (STREET OR HIGHWAY)	SPEED LIMIT
BICYCLIST	VEH. YR(S)	MAKE(S)/MODEL(S)/COLOR(S)	LICENSE NO.(S)		CHP USE ONLY		VEHICLE DAMAGE-EXTENT/LOCATION <input type="checkbox"/> MINOR <input type="checkbox"/> MODERATE <input type="checkbox"/> MAJOR <input type="checkbox"/> TOTAL	
OTHER								

TRAFFIC COLLISION CODING

DATE OF COLLISION: MO. 10 DAY 16 YR. 84 TIME (2400) 1500 NCIC NUMBER CA0370003 OFFICER I.D. 0855 NUMBER 864288

PROPERTY DAMAGE

DESCRIPTION OF DAMAGE

OWNER'S NAME/ADDRESS NOTIFIED YES NO

VIOLATION(S) CHARGED	PARTY 1				PARTY 2				PARTY 3				PARTY 4			
	21802A															
PRIMARY COLLISION FACTOR	RIGHT OF WAY CONTROL				TYPE OF VEHICLE				MOVEMENT PRECEDING COLLISION							
(LIST NUMBER (#) OF PARTY AT FAULT)	A CONTROLS FUNCTIONING				A PASSENGER CAR/STA. WAGON				A STOPPED							
1 21802A	B CONTROLS NOT FUNCTIONING				B PASSENGER CAR W/TRAILER				B PROCEEDING STRAIGHT							
2	C CONTROLS OBSCURED				C MOTORCYCLE/SCOOTER				C RAN OFF ROAD							
3	D NO CONTROLS PRESENT				D PICKUP OR PANEL TRUCK				D MAKING RIGHT TURN							
4					E PICKUP/PANEL TRK W/TRLR				E MAKING LEFT TURN							
C OTHER THAN DRIVER*	TYPE OF COLLISION				F TRUCK OR TRUCK TRACTOR				F MAKING U TURN							
D UNKNOWN*	A HEAD-ON				G TRK/TRK TRACTOR W/TRLR				G BACKING							
WEATHER (MARK 1 TO 2 ITEMS)	B SIDESWIPE				H SCHOOL BUS				H SLOWING-STOPPING							
X A CLEAR	C REAR END				I OTHER BUS				I PASSING OTHER VEHIC							
B CLOUDY	D BROADSIDE				J EMERGENCY VEHICLE				J CHANGING LANES							
C RAINING	E HIT OBJECT				K HWY CONST. EQUIPMENT				K PARKING MANUEVER							
D SNOWING	F OVERTURNED				L BICYCLE				L ENTERING TRAFFIC PR							
E FOG	G AUTO/PEDESTRIAN				M OTHER VEHICLE				L SHOULDER, MEDIAN,							
F OTHER**	H OTHER**				N PEDESTRIAN				L PARKING STRIP OR							
G WIND					O MOPED				PRIVATE DRIVE							
LIGHTING	MOTOR VEHICLE INVOLVED WITH				OTHER ASSOCIATED FACTOR				M OTHER UNSAFE TURNI							
X A DAYLIGHT	A NON-COLLISION				(MARK 1 TO 3 ITEMS)				N XING INTO OPPOSING L							
B DUSK-DAWN	B PEDESTRIAN				A VC SECTION VIOLATION:				O PARKED							
C DARK-STREET LIGHTS	C OTHER MOTOR VEHICLE				B VC SECTION VIOLATION:				P MERGING							
D DARK-NO STREET LIGHTS	D MOTOR VEH. ON OTHER ROADWAY				C VC SECTION VIOLATION:				Q TRAVELING WRONG WA							
E DARK-STREET LIGHTS NOT FUNCTIONING*	E PARKED MOTOR VEHICLE				D VC SECTION VIOLATION:				R OTHER**							
	F TRAIN				E VISION OBSCUREMENTS:				SOBRIETY-DRUG-							
	G BICYCLE				F INATTENTION				PHYSICAL							
ROADWAY SURFACE	H ANIMAL:				G STOP & GO TRAFFIC				(MARK 1 TO 2 ITEMS)							
X A DRY	I FIXED OBJECT:				H ENTERING/LEAVING RAMP				A HAD NOT BEEN DRINK							
B WET	J OTHER OBJECT:				I PREVIOUS COLLISION				B HBD-UNDER INFLUEN							
C SNOWY-ICY					J UNFAMILIAR WITH ROAD				C HBD-NOT UNDER INF							
D SLIPPERY (MUDDY, OILY, ETC.)					K DEFECTIVE VEH. EQUIP.:				D HBD-IMPAIRMENT UN							
					L UNINVOLVED VEHICLE				E UNDER DRUG INFLUEN							
ROADWAY CONDITIONS (MARK 1 TO 3 ITEMS)	PEDESTRIAN'S ACTION				M OTHER*:				F IMPAIRMENT-PHYSIC							
A HOLES, DEEP RUTS*	X A NO PEDESTRIAN INVOLVED				N NONE APPARENT				G IMPAIRMENT NOT KNO							
B LOOSE MATERIAL ON ROADWAY*	B CROSSING IN CROSSWALK AT INTERSECTION				O RUNAWAY VEHICLE				H NOT APPLICABLE							
C OBSTRUCTION ON ROADWAY*	C CROSSING IN CROSSWALK-NOT AT INTERSECTION								I SLEEPY/FATIGUED							
D CONSTRUCTION-REPAIR ZONE	D CROSSING-NOT IN CROSSWALK								SPECIAL INFORMAT							
E REDUCED ROADWAY WIDTH	E IN ROAD-INCLUDES SHOULDER								A HAZARDOUS MATERIA							
F FLOODED*	F NOT IN ROAD								B FIRE INVOLVED*							
G OTHER**	G APPROACHING/LEAVING SCHOOL BUS								C TIRE DEFECT/FAILUR							
X H NO UNUSUAL CONDITIONS																

SKETCH

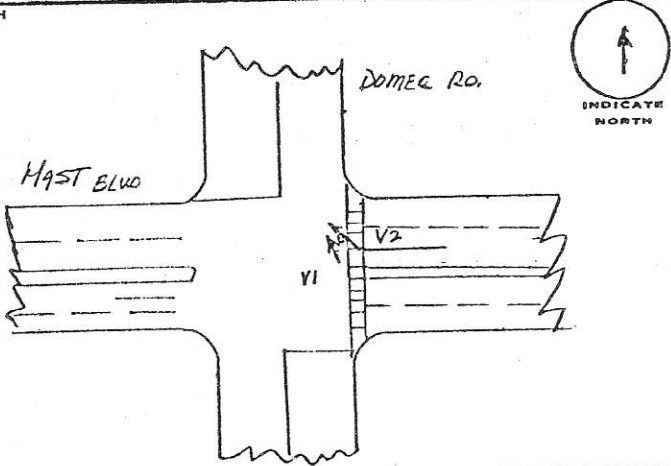

MISCELLANEOUS

POI WAS APPLIC. 60' WEST OF THE ECL OF DOMEQ. RD. AND 268' SATH y TR NCL OF HAST BLVD.
SKID V2
RF 55°
LF 53°

PHYSICAL DESCRIPTION OF PARTY

NUMBER	HAIR	EYES	HEIGHT	WEIGHT

PREPARER'S NAME: E. Wong I.D. NUMBER: 0855 MO. DAY YR.: 10 16 84 REVIEWER'S NAME: C. C. Etell, SU14 MO. DAY: 10 18

*Explain in no

INJURED/WITNESSES/PASSENGERS

DATE OF COLLISION MO. 10 DAY 16 YR. 24			TIME (2400) 0855	NCIC NUMBER CA0370003	OFFICER I.D. 0855	NUMBER 864288
---	--	--	---------------------	--------------------------	----------------------	------------------

WITNESS ONLY	PASSENGER ONLY	AGE	SEX	EXTENT OF INJURY (check one)				INJURED WAS (check one)					PARTY NUMBER
				FATAL INJURY	SEVERE WOUND DISTORTED MEMBER	OTHER VISIBLE INJURIES	COMPLAINT OF PAIN	DRIVER	PASS.	PED.	BICYCLIST	OTHER	
<input type="checkbox"/>	<input type="checkbox"/>	11	F	<input type="checkbox"/>	<input type="checkbox"/>	<input checked="" type="checkbox"/>	<input type="checkbox"/>	<input type="checkbox"/>	<input type="checkbox"/>	<input type="checkbox"/>	<input checked="" type="checkbox"/>	<input type="checkbox"/>	1

NAME: JEANNETTE LYNN DENMAN
 ADDRESS: 9455 PEARLWOOD, SANTEE
 TAKEN TO (INJURED ONLY): GROSSMONT Hosp. TELEPHONE 448-7638

<input type="checkbox"/>	<input type="checkbox"/>	11	F	<input type="checkbox"/>	<input type="checkbox"/>	<input checked="" type="checkbox"/>	<input type="checkbox"/>	<input type="checkbox"/>	<input type="checkbox"/>	<input checked="" type="checkbox"/>	<input type="checkbox"/>	<input type="checkbox"/>	1
--------------------------	--------------------------	----	---	--------------------------	--------------------------	-------------------------------------	--------------------------	--------------------------	--------------------------	-------------------------------------	--------------------------	--------------------------	---

NAME: AMY A. OSTASHAY
 ADDRESS: 9523 HARKWOOD, SANTEE
 TAKEN TO (INJURED ONLY): GROSSMONT Hosp. TELEPHONE 562-5294

<input checked="" type="checkbox"/>	<input type="checkbox"/>	29	M	<input type="checkbox"/>	<input type="checkbox"/>	<input type="checkbox"/>	<input type="checkbox"/>	<input type="checkbox"/>	<input type="checkbox"/>	<input type="checkbox"/>	<input type="checkbox"/>	<input type="checkbox"/>	
-------------------------------------	--------------------------	----	---	--------------------------	--------------------------	--------------------------	--------------------------	--------------------------	--------------------------	--------------------------	--------------------------	--------------------------	--

NAME: GUY MICHAEL BROSLON
 ADDRESS: 9627 CALLETON HILLS BLVD #2 SANTEE
 TAKEN TO (INJURED ONLY): TELEPHONE 562-6450

<input checked="" type="checkbox"/>	<input type="checkbox"/>	29	F	<input type="checkbox"/>	<input type="checkbox"/>	<input type="checkbox"/>	<input type="checkbox"/>	<input type="checkbox"/>	<input type="checkbox"/>	<input type="checkbox"/>	<input type="checkbox"/>	<input type="checkbox"/>	
-------------------------------------	--------------------------	----	---	--------------------------	--------------------------	--------------------------	--------------------------	--------------------------	--------------------------	--------------------------	--------------------------	--------------------------	--

NAME: VICKI W. AUSTIN
 ADDRESS: 9420 DOHENY, SANTEE
 TAKEN TO (INJURED ONLY): TELEPHONE 449-0121

<input checked="" type="checkbox"/>	<input type="checkbox"/>	15	F	<input type="checkbox"/>	<input type="checkbox"/>	<input type="checkbox"/>	<input type="checkbox"/>	<input type="checkbox"/>	<input type="checkbox"/>	<input type="checkbox"/>	<input type="checkbox"/>	<input type="checkbox"/>	
-------------------------------------	--------------------------	----	---	--------------------------	--------------------------	--------------------------	--------------------------	--------------------------	--------------------------	--------------------------	--------------------------	--------------------------	--

NAME: KIMBERLY A. AUSTIN
 ADDRESS: 9420 DOHENY, SANTEE
 TAKEN TO (INJURED ONLY): TELEPHONE 449-0121

<input checked="" type="checkbox"/>	<input type="checkbox"/>	30	F	<input type="checkbox"/>	<input type="checkbox"/>	<input type="checkbox"/>	<input type="checkbox"/>	<input type="checkbox"/>	<input type="checkbox"/>	<input type="checkbox"/>	<input type="checkbox"/>	<input type="checkbox"/>	
-------------------------------------	--------------------------	----	---	--------------------------	--------------------------	--------------------------	--------------------------	--------------------------	--------------------------	--------------------------	--------------------------	--------------------------	--

NAME: JANET B. CRAIG
 ADDRESS: 9458 ST. ANDREWS, SANTEE
 TAKEN TO (INJURED ONLY): TELEPHONE 562-9512

<input checked="" type="checkbox"/>	<input type="checkbox"/>	25	F	<input type="checkbox"/>	<input type="checkbox"/>	<input type="checkbox"/>	<input type="checkbox"/>	<input type="checkbox"/>	<input type="checkbox"/>	<input type="checkbox"/>	<input type="checkbox"/>	<input type="checkbox"/>	
-------------------------------------	--------------------------	----	---	--------------------------	--------------------------	--------------------------	--------------------------	--------------------------	--------------------------	--------------------------	--------------------------	--------------------------	--

NAME: PEGGY M. BUEHLER
 ADDRESS: 9641 FRASCATI WAY, SANTEE
 TAKEN TO (INJURED ONLY): TELEPHONE 562-1234

<input type="checkbox"/>	<input type="checkbox"/>			<input type="checkbox"/>	<input type="checkbox"/>	<input type="checkbox"/>	<input type="checkbox"/>	<input type="checkbox"/>	<input type="checkbox"/>	<input type="checkbox"/>	<input type="checkbox"/>	<input type="checkbox"/>	
--------------------------	--------------------------	--	--	--------------------------	--------------------------	--------------------------	--------------------------	--------------------------	--------------------------	--------------------------	--------------------------	--------------------------	--

NAME: [Blank]
 ADDRESS: [Blank]
 TAKEN TO (INJURED ONLY): TELEPHONE [Blank]

<input type="checkbox"/>	<input type="checkbox"/>			<input type="checkbox"/>	<input type="checkbox"/>	<input type="checkbox"/>	<input type="checkbox"/>	<input type="checkbox"/>	<input type="checkbox"/>	<input type="checkbox"/>	<input type="checkbox"/>	<input type="checkbox"/>	
--------------------------	--------------------------	--	--	--------------------------	--------------------------	--------------------------	--------------------------	--------------------------	--------------------------	--------------------------	--------------------------	--------------------------	--

NAME: [Blank]
 ADDRESS: [Blank]
 TAKEN TO (INJURED ONLY): TELEPHONE [Blank]

<input type="checkbox"/>	<input type="checkbox"/>			<input type="checkbox"/>	<input type="checkbox"/>	<input type="checkbox"/>	<input type="checkbox"/>	<input type="checkbox"/>	<input type="checkbox"/>	<input type="checkbox"/>	<input type="checkbox"/>	<input type="checkbox"/>	
--------------------------	--------------------------	--	--	--------------------------	--------------------------	--------------------------	--------------------------	--------------------------	--------------------------	--------------------------	--------------------------	--------------------------	--

NAME: [Blank]
 ADDRESS: [Blank]
 TAKEN TO (INJURED ONLY): TELEPHONE [Blank]

<input type="checkbox"/>	<input type="checkbox"/>			<input type="checkbox"/>	<input type="checkbox"/>	<input type="checkbox"/>	<input type="checkbox"/>	<input type="checkbox"/>	<input type="checkbox"/>	<input type="checkbox"/>	<input type="checkbox"/>	<input type="checkbox"/>	
--------------------------	--------------------------	--	--	--------------------------	--------------------------	--------------------------	--------------------------	--------------------------	--------------------------	--------------------------	--------------------------	--------------------------	--

NAME: [Blank]
 ADDRESS: [Blank]
 TAKEN TO (INJURED ONLY): TELEPHONE [Blank]

WITNESS ONLY	PASSENGER ONLY	AGE	SEX	EXTENT OF INJURY (check one)				INJURED WAS (check one)					PARTY NUMBER
				FATAL INJURY	SEVERE WOUND DISTORTED MEMBER	OTHER VISIBLE INJURIES	COMPLAINT OF PAIN	DRIVER	PASS.	PED.	BICYCLIST	OTHER	

PREPARER'S NAME: E. WONG
 I.D. NUMBER: 0855
 MO. DAY YR.: 10 16 24
 REVIEWED - APPROVED BY: C. G. (Tall, SUT 4)
 MO. DAY YR.: 10 18 84

PT	R.L1	RL2	DISC
A	W 6 ⁰	S 20 ⁸	P.O.I
A1	W 6 ⁰	S 20 ⁸	START OF BICYCLE SCUFF
A2	W 7 ⁸	S 20 ⁸	END OF BICYCLE SCUFF
B	E 20 ⁸	S 19 ¹⁰	START OF RIF SKID
B1	Ø	S 16 ¹⁰	20' OF RIF SKID
B2	W 20 ⁰	S 12 ¹⁰	20' OF RIF SKID
B3	W 34 ⁷	S 10 ³	END OF RIF SKID
C	W 28 ³	S 9 ³	RIR OF V-2
D	W 40 ¹¹	S 1 ³	RIF OF V-2
E	E 16 ⁰	S 34 ⁸	RIF AUSTIN VAN
F	E 34 ⁶	S 34 ⁰	RIR AUSTIN VAN

LEGEND
 RL1 ECL DOMER RD
 RL2 NCL MAST BL
 NOT TO SCALE
 M.J. MEDEARIS

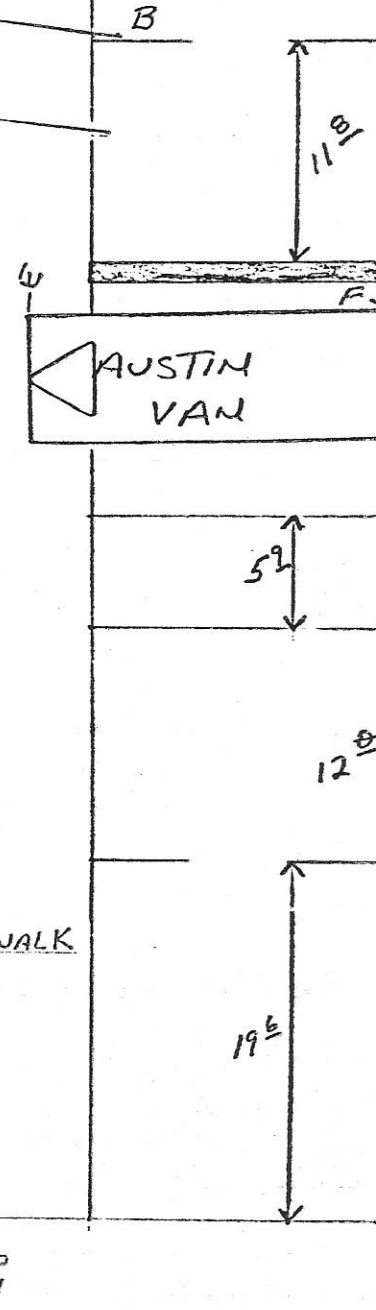

PREPARED BY NAME	ID NUMBER	MO. DAY YR	REVIEWER'S NAME	MO. DAY YR
M.J. MEDEARIS	Ø656	10 16 84	J. C. [Signature]	10 18 84

DATE OF COLLISION	TIME	NCIC NUMBER	OFFICER ID	NUMBER
MO. 10 DAY 16 YR 84	1500	CA 0370003	0855	864288

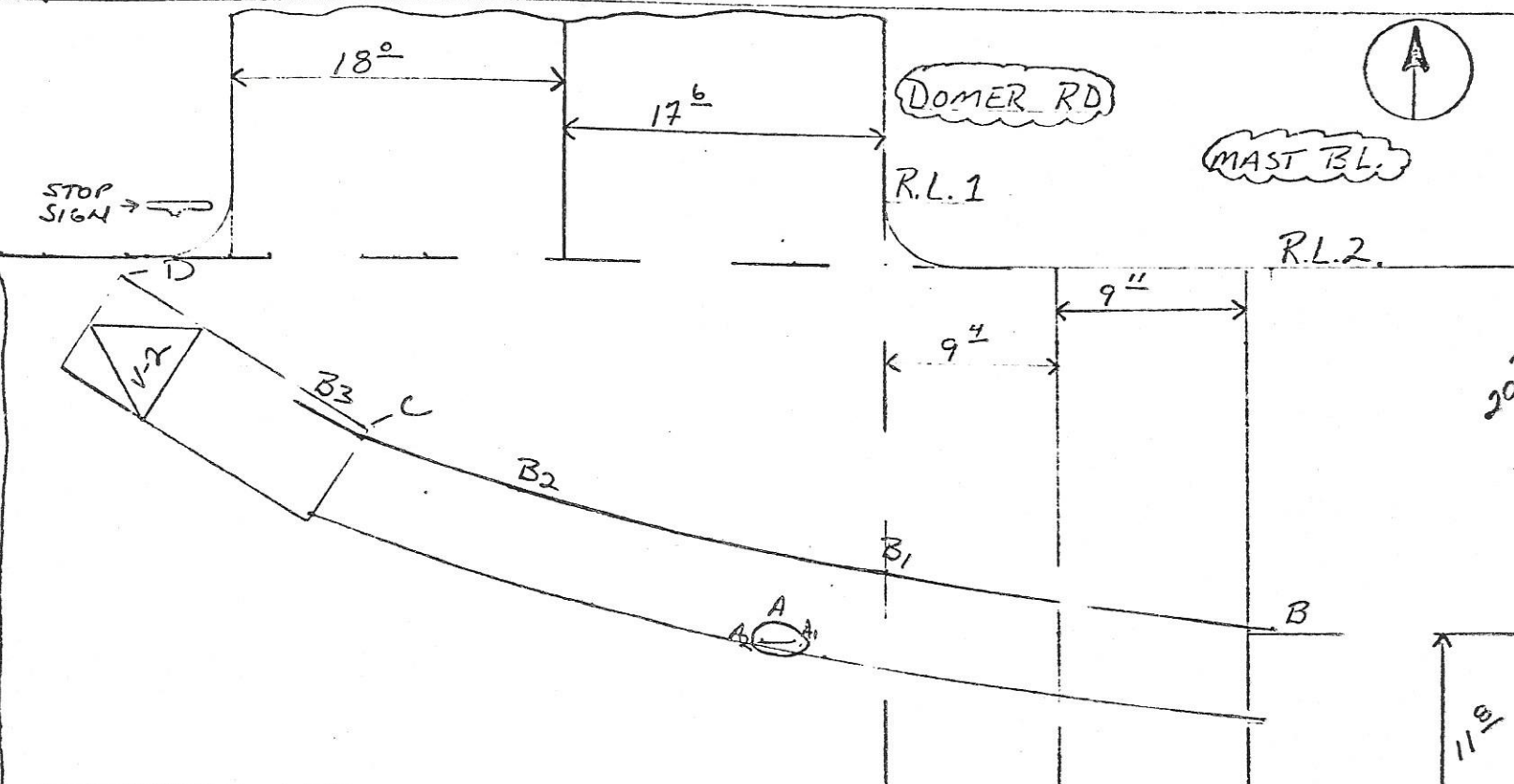

PT	R.L.1	RL2	DISC
A	W 6°	S 20°	P.O.I
A1	W 6°	S 20°	START OF BICYCLE SCUFF
A2	W 7°	S 20°	END OF BICYCLE SCUFF
B	E 20°	S 19°	START OF RIF SKID
B1	⊖	S 16°	20' OF RIF SKID
B2	W 20°	S 12°	20' OF RIF SKID
B3	W 34°	S 10°	END OF RIF SKID
C	W 28°	S 9°	RIF OF V-2
D	W 40°	S 1°	RIF OF V-2
E	E 16°	S 34°	RIF AUSTIN VAN

LEGEND
 RL1 ECL DOMER RD
 RL2 NCL MAST BL
 NOT TO SCALE
 M.J. MEDEARIS

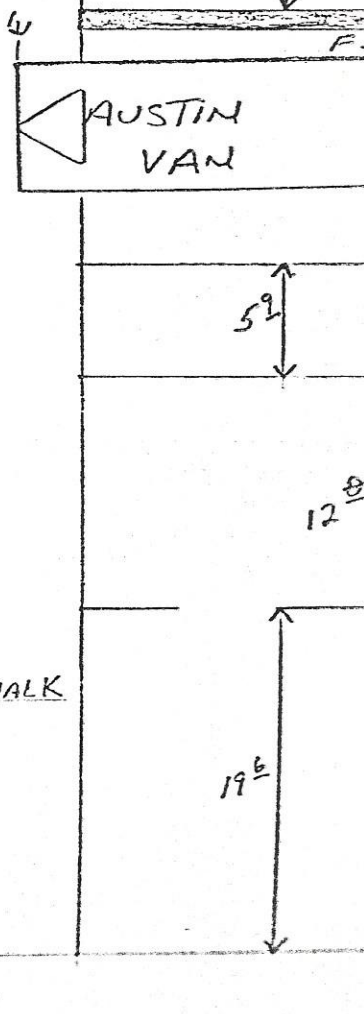

NARRATIVE/SUPPLEMENTAL

CHECK ONE <input checked="" type="checkbox"/> NARRATIVE <input type="checkbox"/> SUPPLEMENTAL		CHECK ONE <input checked="" type="checkbox"/> COLLISION REPORT <input type="checkbox"/> OTHER:	
DATE OF ORIGINAL INCIDENT MO. 10 DAY 16 YR. 84	TIME (2400) 1500	NCIC NUMBER CA0270083	OFFICER I.D. NUMBER 0855 864288
CITY/COUNTY/JUDICIAL DISTRICT SANTEE SAN DIEGO/EL CAJON		REPORTING DISTRICT/BEAT 14 15	CITATION NUMBER 463951-2
LOCATION/SUBJECT			

FACTS

COMMUNICATIONS REPORTED AN UNKNOWN HIT/STUCK STATUS ACCIDENT AT 1507 HRS. MY TIME OF ARRIVAL FROM THE SANTEE SHERIFFS' STATION WAS 1515 HRS.

(SCENE)

MAST BLVD. IN THE AREA OF THE COLLISION IS A RELATIVELY FLAT STRAIGHT ASPHALT, EAST/WEST ROADWAY DIVIDED BY A RAISED CENTER ISLAND. TWO LINES OF TRAVEL ARE LOCATED IN EACH DIRECTION. BOTH SIDES OF MAST BLVD. ARE BORDERED BY RAISED CURBS AND SIDEWALKS. LEFT TURN LANES ARE LOCATED FOR BOTH EAST AND WEST BOUND DIRECTIONS AT DOMER RD. DOMER RD. AT MAST BLVD. IS A RELATIVELY FLAT, STRAIGHT, NORTH/SOUTH, ASPHALT ROADWAY. DOMER RD. INTERSECTS MAST BLVD. AT RIGHT ANGLES. STOP SIGNS CONTROL BOTH NORTH AND SOUTH BOUND DIRECTION ON DOMER RD. AT MAST BLVD. A MARKED CROSSWALK WITH VERTICAL STRIPES IS LOCATED FACING WEST/EAST MAST BLVD EAST OF DOMER RD. AN ELEMENTARY SCHOOL IS LOCATED NEARBY ON DOMER RD SOUTH OF MAST BLVD. THE POSTED SPEED LIMIT ON MAST BLVD. IS 35 MPH. THE SPEED LIMIT ON DOMER RD. IS 25 MPH. THIS COLLISION OCCURRED WITHIN A RESIDENTIAL DISTRICT.

PREPARER'S NAME E. Wong	I.D. NUMBER 0855	MO. DAY YR. 10 16 84	REVIEWED - APPROVED BY C. G. C. SGT 4	MO. DAY YR. 10 18 84
----------------------------	---------------------	-------------------------	--	-------------------------

SAN DIEGO COUNTY SHERIFF'S DEPARTMENT

NARRATIVE/SUPPLEMENTAL

CHECK ONE
 NARRATIVE SUPPLEMENTAL

CHECK ONE
 COLLISION REPORT OTHER:

DATE OF ORIGINAL INCIDENT NO. 10 DAY 16 YR. 84	TIME (2400) 1500	NCIC NUMBER CA027002E	OFFICER I.D. 0855	NUMBER 864288
CITY/COUNTY/JUDICIAL DISTRICT Santee / San Diego / El Cajon		REPORTING DISTRICT/BEAT 14 / 15	CITATION NUMBER 462951-2	
LOCATION/SUBJECT				

(PARTIES AND VEHICLES)

PARTY 1 DENMAN WAS LOCATED SEATED ON THE N/W CORNER OF DOMER RD. AND HAST BLVD. SHE WAS BEING ATTENDED TO BY THE Santee FIRE PERSONNEL. V1 WAS LOCATED LYING ON IT'S LEFT SIDE AT A CONTROLLED POR ON THE NW CORNER OF DOMER RD & HAST BLVD. VISIBLE DAMAGES WERE LOCATED ON THE FRONT WHEEL, FRONT FORKS! SCRAPES WERE LOCATED ON THE SIDE OF THE LEFT PEDAL, AND THE LEFT SIDE OF THE FRONT SEAT. DENMAN WAS IDENTIFIED VERBALLY.

PARTY 2 AURECH WAS LOCATED SPEAKING TO DEP. MEDENRIS IN THE INTERSECTION OF DOMER AND HAST BLVD. AURECH WAS IDENTIFIED WITH A VALID CALIF. DRIVER LICENSE REQUIRING CORRECTIVE LENSES. AURECH WAS WEARING EYE GLASSES. V2 WAS LOCATED AT AN UNCONTROLLED POR FACING N/W ACROSS THE W/L LANE OF HAST BLVD AT DOMER RD. VISIBLE DAMAGES WERE LOCATED ON THE LEFT FRONT DOOR, L REAR FENDER AND THE LEFT REAR HUBCAP.

(INJURIES)

DENMAN SUSTAINED AN ABRASION ON HER LEFT ELBOW. OSTASHAY REPORTED SHE WAS UNINJURED. HOWEVER, THE FIRE DEPT. PERSONNEL APPLIED C-COLLARS ON DENMAN AND OSTASHAY. (REFER TO REPORT FOR FURTHER)

(PHYSICAL EVIDENCE)

VISIBLE SKID WAS LOCATED IN THE ^{ORIGINATING} W/L LANE OF HAST BLVD. AND EXTENDED TO THE POR OF V2. THIS SKID WAS ALSO IDENTIFIED BY AURECH AS COMING FROM HIS VEHICLE. A SCRAPER ON HAST BLVD. WAS ALSO LOCATED IN

PREPARER'S NAME E. Wong	I.D. NUMBER 0855	MO. DAY YR. 10 16 84	REVIEWED - APPROVED BY C. C. Chiu, SUT ⁴	MO. DAY YR. 10 18 84
----------------------------	---------------------	-------------------------	--	-------------------------

NARRATIVE/SUPPLEMENTAL		CHECK ONE <input checked="" type="checkbox"/> NARRATIVE <input type="checkbox"/> SUPPLEMENTAL		CHECK ONE <input checked="" type="checkbox"/> COLLISION REPORT <input type="checkbox"/> OTHER:	
DATE OF ORIGINAL INCIDENT NO. 10 DAY 16 YR. 84	TIME (2400) 1500	NCIC NUMBER CA020003	OFFICER I.D. 0855	NUMBER 864288	
CITY/COUNTY/JUDICIAL DISTRICT SANTEE / SAN DIEGO / EL CAJON		REPORTING DISTRICT/BEAT 14 15		CITATION NUMBER 462951-2	
LOCATION/SUBJECT					

THE AREA OF THE COLLISION. RED COLOR PAINT TRANSFER WAS LOCATED ON 1/2 LEFT FRONT DOOR.

STATEMENTS

PARTY 1 DENMAN STATED SHE WAS RIDING HER BICYCLE AND OSTASHKI WAS RIDING DOUBLE ON THE SEAT. DENMAN WAS RIDING NE ACROSS THE EB LANES OF HAST BLVD. AT DOMERKO IN THE MARKED CROSSWALK. AS SHE WAS APPROACHING THE CENTER OF THE ROADWAY, A VAN STOPPED IN THE WB LEFT TURN LANE. SEEING THAT THE VAN HAD STOPPED FOR HER, DENMAN CONTINUED RIDING WITHIN THE CROSSWALK, BUT THEN SHE BEGUN TO MOVE TO HER LEFT OUT OF THE CROSSWALK BECAUSE THE RAISED CENTER ISLAND EXTENDED ALL THE WAY INTO THE CROSSWALK. WHEN DENMAN PASSED THE RIGHT SIDE OF THE STOPPED VAN, SHE SUDDENLY SAW AVECH APPROACHING ON RIGHT. DENMAN SWERVED TO HER LEFT, BUT A COLLISION OCCURRED WHERE BOTH GIRLS WERE KNOCKED OFF OF THE BICYCLE. DENMAN LANDED ON THE GROUND.

OSTASHKI STATED SHE WAS RIDING ON THE SEAT OF DENMAN'S BICYCLE AND DENMAN WAS STANDING AND PUMPING THE BICYCLE ACROSS HAST BLVD. THEY THEN BECAME INVOLVED IN A COLLISION WITH AN AUTOMOBILE WHICH CAUSED OSTASHKI TO SUMMERLANDT OFF OF THE BICYCLE.

PARTY 2 AVECH STATED HE WAS TRAVELING IN THE W1 LANE OF HAST BLVD. AND HIS SPEED WAS APPROX. 25-30 MPH. AS AVECH WAS APPROACHING DOMER ED, HE SAW DENMAN ENTERING HIS PATH FROM HIS LEFT SIDE. AVECH BELIEVED DENMAN WAS 15 FT. AWAY WHEN HE FIRST SAW HER. AVECH SWERVED

PREPARER'S NAME E. WONG	I.D. NUMBER 0855	MO. DAY YR. 10 16 84	REVIEWED - APPROVED BY C. G. Hall, SUT ⁴	MO. DAY YR. 10 18 84
----------------------------	---------------------	-------------------------	--	-------------------------

NARRATIVE/SUPPLEMENTAL

CHECK ONE
 NARRATIVE SUPPLEMENTAL

CHECK ONE
 COLLISION REPORT OTHER:

DATE OF ORIGINAL INCIDENT MO. 10 DAY 16 YR. 84	TIME (2400) 1500	NCIC NUMBER CA0370003	OFFICER I.D. NUMBER 0855	CITATION NUMBER 86A288 46351-2
CITY/COUNTY/JUDICIAL DISTRICT SANTEE / SAN DIEGO / EL CAJON		REPORTING DISTRICT/BEAT 14 15		
LOCATION/SUBJECT				

TO HIS LIGHT AND BRAKED. THE BICYCLE THEN COLLIDED INTO THE SIDE OF HIS VEHICLE AND DENMAN AND OSTASHAY WERE KNOCKED DOWN TO THE GROUND.

BROGDON STATED HE WAS IN THE W2 LANE OF MAST BLVD. AND HE WAS BEHIND AVRECH. AVRECH WAS ALSO IN THE W2 LANE AND AVRECH WAS GOING BETWEEN 25-30 MPH. AS THEY WERE APPROACHING COMER RD., A VAN HAD STOPPED IN THE WE LEFT TURN LANE. DENMAN THEN SUDDENLY APPEARED ON HER BICYCLE AND AVRECH WAS APPROX. 10 FT. AWAY FROM THEM. DENMAN WAS NEAR MAST BLVD. AVRECH SWERVED TO HIS RIGHT AND DENMAN COLLIDED INTO THE SIDE OF AVRECH'S VEHICLE. BROGDON WAS APPROX. 50 FT. BEHIND AVRECH WHEN THE COLLISION OCCURRED.

VICKI AUSTIN STATED SHE WAS DRIVING A 1976 DODGE VAN, GREEN IN COLOR, CALIF. LICENSE 1CNJ834, WE ON MAST BLVD. WHEN AUSTIN ENTERED THE LEFT TURN LANE, SHE SAW DENMAN ON A BICYCLE AND OSTASHAY RIDING DOUBLE ON THE REAR SEAT. DENMAN WAS RIDING HB ON THE CROSSWALK AND AUSTIN STOPPED HER VAN FOR THE GIRLS, BUT SHE DID NOT WAVE THEM THROUGH. THE GIRLS WERE GIBLING AS THEY PASSED IN FRONT OF HER VAN. DENMAN HAD TO RIDE OUT FROM THE CROSSWALK TO GET AROUND THE ISLAND. AS DENMAN PASSED HER RIGHT FENDER LINE, AVRECH APPEARED FROM BEHIND. AUSTIN DID NOT SEE AVRECH UNTIL AVRECH WAS BESIDE HER VAN. WHEN DENMAN ENTERED AVRECH'S PATH, AVRECH WAS ONLY 6 TO 8 INCHES AWAY. AVRECH SWERVED TO THE RIGHT, BUT A COLLISION OCCURRED. BOTH KIDS AND THE BICYCLE THEN FLEW INTO THE AIR.

PREPARER'S NAME E. Wong	I.D. NUMBER 0855	MO. DAY YR. 10 16 84	REVIEWED - APPROVED C. C. (Haw), SGT 4	MO. DAY YR. 10 18 84
----------------------------	---------------------	-------------------------	---	-------------------------

NARRATIVE/SUPPLEMENTAL		CHECK ONE <input checked="" type="checkbox"/> NARRATIVE <input type="checkbox"/> SUPPLEMENTAL		CHECK ONE <input checked="" type="checkbox"/> COLLISION REPORT <input type="checkbox"/> OTHER:	
DATE OF ORIGINAL INCIDENT MO. 10 DAY 16 YR. 84		TIME (2400) 1500	NCIC NUMBER C10370003	OFFICER I.D. 0955	NUMBER 864288
CITY/COUNTY/JUDICIAL DISTRICT SANTEE / SAN DIEGO / EL CAJON			REPORTING DISTRICT/BEAT 14/15	CITATION NUMBER	
LOCATION/SUBJECT					

SHE DOESN'T KNOW HOW FAST AURECH WAS GOING. AUSTIN WAS STOPPED DIRECTLY BEHIND THE LIMIT LINE.

KIMBELLY AUSTIN STATED SHE WAS RIDING IN THE LEFT FRONT SEAT OF HER HUSBAND'S VEHICLE. SHE SAW AURECH WHEN AURECH WAS ALMOST NEXT TO HER WHEN HER MOTOR WAS STOPPED IN THE LEFT TURN LANE. SHE DESCRIBED AURECH AS GOING A "REGULAR" SPEED, NOT TOO FAST OR SLOW. AURECH HIT HIS BRAKES AND SKIDDED TO AVOID A COLLISION, BUT A COLLISION OCCURRED.

CRANE STATED SHE WAS WB IN LANE 1 ON HAST BLVD. SHE WAS TRAVELING APPROX 33 MPH. AT THIS TIME. SHE SAW AURECH APPROACHING FROM BEHIND AND SHE COULD TELL FROM THE WAY AURECH'S CAR WAS BEING DRIVEN THAT HE WAS IN A HURRY. AURECH PASSED HER IN W1 AND AURECH TRIED TO MOVE INTO W1, BUT WAS UNABLE TO AT FIRST DUE TO ANOTHER SLOWER MOVING VEHICLE IN W1. AURECH FINALLY WAS ABLE TO ENTER THE W1 LANE AND HE THEN REACCELERATED WHEN WAS APPROX. 125' AWAY IN FRONT. CRAIG SAW SMOKE COMING FROM AURECH'S VEHICLE, BUT DID NOT SEE THE IMPACT. CRAIG BELIEVED AURECH WAS GOING MUCH TOO FAST ON HAST BLVD. CRAIG WAS BEHIND BUEHLER.

BUEHLER STATED SHE WAS WB IN LANE 1 ON HAST BLVD AND SHE WAS GOING APPROX. 30 MPH. A CHRY. TRUCK WAS SLIGHTLY IN FRONT OF HER IN W1. SHE SAW IN HER MIRROR AURECH COMING UP AND IT WAS OBVIOUS HE WAS IN A HURRY. AURECH WAS IN W2 AND BUEHLER FELT AURECH WANTED TO GET IN FRONT OF HER, BUT COULDN'T BECAUSE OF THE TIGHT SPACE BETWEEN HER AND

PREPARED BY E. Wong	I.D. NUMBER 0955	MO. DAY YR. 10 16 84	REVIEWED - APPROVED BY C. G. [Signature]	MO. DAY YR. 10 18 84
------------------------	---------------------	-------------------------	---	-------------------------

SAN DIEGO COUNTY SHERIFF'S DEPARTMENT

NARRATIVE/SUPPLEMENTAL

CHECK ONE
 NARRATIVE SUPPLEMENTAL

CHECK ONE
 COLLISION REPORT OTHER:

DATE OF ORIGINAL INCIDENT MO. 10 DAY 16 YR. 84	TIME (2400) 1500	NCIC NUMBER CA0370003	OFFICER I.D. 0855	NUMBER 964288
CITY/COUNTY/JUDICIAL DISTRICT Santee / SAN DIEGO / ELCAJON		REPORTING DISTRICT/BEAT 14 15		CITATION NUMBER 463951-2
LOCATION/SUBJECT				

THE CHED. TRACK IN W/2. BUEHLER THEN BACKED OFF OF HER ACCELERATOR AND SLOWED DOWN TO LET AURECH IN. AURECH THEN CHANGED INTO W/1. BUEHLER THEN SAW A VAN STOP IN THE LEFT TURN LANE AT WB HAST AT DORNER. TWO BIKE TIRES WERE SEEN BY BUEHLER TO BE PASSING IN FRONT OF THE VAN FROM LEFT TO RIGHT. AT THIS TIME AURECH'S SPEED WAS ESTIMATED TO BE 40 MPH. THE BICYCLE (DENMAN) ENTERED AURECH'S PATH WHEN AURECH WAS APPROX. 60' AWAY. AURECH THEN SKIDDED AND A COLLISION OCCURRED.

OPINIONS AND CONCLUSIONS

AUSTIN WAS STOPPED IN THE LEFT TURN LANE OF WB HAST BLVD. AT DORNER RD. DENMAN WAS RIDING A BICYCLE NE ACROSS HAST BLVD. ON DORNER RD. OSTASHAY WAS RIDING DOUBLE ON THE SEAT OF DENMAN'S BICYCLE. AURECH WAS WB IN LANE 1 ON HAST BLVD. APPROACHING DORNER RD. DENMAN SUDDENLY APPEARED FROM THE RIGHT FENDER LINE OF AUSTIN'S VAN. AURECH TOOK EVASIVE ACTION BY SWERVING TO HIS RIGHT AND BRAKING. DENMAN ALSO SWERVED TO HER LEFT AND A SIDESWIRE COLLISION OCCURRED. DENMAN AND OSTASHAY WERE KNOCKED TO THE GROUND.

CRIME

AUSTIN WAS STOPPED AT THE UNIT LINE IN THE WE LEFT TURN LANE ON HAST AT DORNER AND COMMUNICATED TO DENMAN THAT AUSTIN WAS YIELDING TO HER. DENMAN ORIGINALLY WAS NE IN THE CROSSWALK, BUT SHE WAS RIDING A BICYCLE AND SHE DID NOT HAVE PEDESTRIAN STATUS. DENMAN WAS TRAIL OPERATING

PREPARED BY NAME E. WONG	I.D. NUMBER 0855	MO. DAY YR. 10 16 84	REVIEWED - APPROVED BY C. C. C. SUT 4	MO. DAY YR. 10 18 84
-----------------------------	---------------------	-------------------------	--	-------------------------

NARRATIVE/SUPPLEMENTAL

CHECK ONE



NARRATIVE



SUPPLEMENTAL

CHECK ONE

 COLLISION REPORT

OTHER:

DATE OF ORIGINAL INCIDENT

TIME (2400)

NCIC NUMBER

OFFICER I.D.

NUMBER

NO. 10 DAY 16 YR. 84

1500

CA0270003

0855

864288

CITY/COUNTY/JUDICIAL DISTRICT

REPORTING DISTRICT/BEAT

CITATION NUMBER

SANTOE/SAN DIEGO/EL CAJON

14 15

463951-2

LOCATION/SUBJECT

A VEHICLE ON THE ROADWAY AND SHE WAS REQUIRED TO OBEY THE SAME RULES AND LEGISLATIONS WHICH APPLY TO MOTOR VEHICLES. WHEN AUSTIN STOPPED FOR DENMAN, DENMAN'S LIGHT OF WAY ONLY EXTENDED TO THE REAR FENDER LINE OF AUSTIN'S VEHICLE. ANY POINT BEYOND THIS, DENMAN WAS REQUIRED TO STOP AND YIELD TO APPROACHING VEHICLES WHICH ARE CLOSE ENOUGH TO BE A HAZARD SINCE DOMEK RD IS CONTROLLED BY STOP SIGNS AND MUST BLVD. IS A THROUGH ROAD. HOWEVER, DENMAN RODE PAST AUSTIN WITHOUT USING CAUTION.

AURECH WAS WR IN LANE 1 ON MUST BLVD. PRIOR TO COLLIDING WITH DENMAN, AURECH SKIDDED HIS VEHICLE AND LEFT 55° OF SKID WITH HIS RF TIRE AND 53° OF SKID WITH THE LF TIRE. USING A STANDARD COEFFICIENT OF FRICTION OF .70 FOR MUST BLVD, AURECH'S MINIMUM SPEED PRIOR TO SKIDDING WAS CALCULATED TO BE 33.9 MPH. (REFER TO SKID SHEET) THE POSTED SPEED LIMIT ON MUST BLVD. IS 35 MPH. WITNESSES BUELER AND CRAIG BOTH STATED THEY SAW AURECH DRIVING AS IF HE WAS IN A HURRY. CRAIG STATED SHE WAS GOING 33 MPH AND AURECH PASSED HER, BUEHLER ESTIMATED AURECH SPEED OF 40 MPH. IF AURECH WAS SPEEDING PRIOR TO THE COLLISION, ^{THIS} IS IMMATERIAL TO THAT OCCURRED BEFORE HE REACHED DOMEK RD. THE PHYSICAL EVIDENCE LEFT AT THE SCENE OF THE ACCIDENT (SKID) SHOWED AURECH WAS TRAVELING WITHIN THE POSTED 35 MPH LIMIT. (33.9 MPH)

AURECH'S VISION WAS OBSCURED TO HIS LEFT BY AUSTIN'S VAN, THE VAN MEASURED 18⁵ LONG, 6¹⁰ HIGH, AND 7⁵ WIDE. THE VAN ALSO OBSCURED DENMAN'S VISION TO HER RIGHT ALSO. IF THE OBSCUREMENT WAS NOT PRESENT, IT WOULD HAVE GIVEN AURECH AND DENMAN AN EARLIER OPPORTUNITY TO SEE EACH OTHER.

AURECH PREVENTED A BROADSIDE COLLISION BY EFFECTIVELY SWERVING TO HIS RIGHT. THIS COMBINED WITH DENMAN'S SWERVE TO HER LEFT PREVENTED A MORE SERIOUS OR FATAL INJURIES. DENMAN'S BICYCLE COLLIDED INTO THE LEFT FRONT

PREPARER'S NAME

I.D. NUMBER

MO. DAY YR.

REVIEWED - APPROVED BY

NO. DAY YR.

E. Wong

0855

10 16 84

C. G. (C. G. SUT 4)

10 18 84

TR-3 (1-83)

Use previous editions until depleted.

NARRATIVE/SUPPLEMENTAL

CHECK ONE
 NARRATIVE SUPPLEMENTAL

CHECK ONE
 COLLISION REPORT OTHER:

DATE OF ORIGINAL INCIDENT MO. 10 DAY 16 YR. 84	TIME (2400) 1500	NCIC NUMBER CA0370003	OFFICER I.D. 0835	NUMBER 864288
CITY/COUNTY/JUDICIAL DISTRICT SANTEE / SAN DIEGO / EL CAJON		REPORTING DISTRICT/BEAT 14 15	CITATION NUMBER 463951-2	
LOCATION/SUBJECT				

DOOR OF AURECH WITH THE RIGHT SIDE OF THE FRONT TIRE AND FORK. THIS COLLISION LEFT THE PAINT TRANSFER FOUND ON AURECH'S FRONT DOOR. THE BICYCLE THEN ROTATED TO THE RIGHT AND A SECONDARY COLLISION THEN OCCURRED ON THE REAR FENDER AND REAR HUBCAP. THE BICYCLE THEN FELL ON ITS LEFT SIDE CAUSING DAMAGE TO THE LEFT PEDAL AND LEFT SIDE OF THE SEAT. THIS THEN DEPOSITED THE SCRAPE MARK ON MARST BLVD.

OSTASHAY AND DENMAN WERE RIDING DOUBLE ON THE BICYCLE. THIS IN ITSELF DID NOT CONTRIBUTE TO THE COLLISION. THE COLLISION WOULD STILL HAVE OCCURRED IF DENMAN WAS THE SOLE RIDER IF ALL OF THE OTHER EVENTS WERE THE SAME.

THE PRIMARY CAUSE OF THE COLLISION IS DENMAN'S FAILURE TO YIELD THE RIGHT OF WAY TO AURECH BECAUSE SHE NORMALLY STOPPED TO CHECK IF IT WAS SAFE TO GO. SHE SAID AIDED STOP FOR HZL (21802A VC)

UPDATED (10/17) INJURIES REPORTED ON DENMAN WERE A STIFF NECK WITH SCIAPOR AND BRUISES ON HER BODY. A BUMP IS ALSO LOCATED ON THE BASE OF HER HEAD. DENMAN ALSO VOMITED SEVERAL TIMES AT THE ER. X RAYS OF HER HEAD WERE NEGATIVE.

OSTASHAY SUSTAINED ABRASIONS ON HER RT ANKLE AND RT. CALF, LOWER BACK, AND RT. ELBOW, AND ON THE RT SIDE OF HER HEAD.

POINT OF IMPACT THE POI WAS DETERMINED FROM PHYSICAL EVIDENCE AND STATEMENTS.

RECOMMENDATION

A COMPLAINT CHARGING DENMAN WITH VIOLATING 21802A VC AND 21204B VC, AND OSTASHAY WITH 21204B VC IS REQUESTED

PREPARED BY L Wong	I.D. NUMBER 855	MO. DAY YR. 10 17 84	REVIEWED - APPROVED BY C. C. (Stul, SUT)	MO. DAY YR. 10 18 84
-----------------------	--------------------	-------------------------	---	-------------------------